

- EXISTING PIPELINES
- STATE TRACT LINES
- PROPOSED ACCESS ROUTE
- COE NAVIGATIONAL CHANNELS
(DATA OBTAINED FROM US ARMY
CORPS OF ENGINEERS)

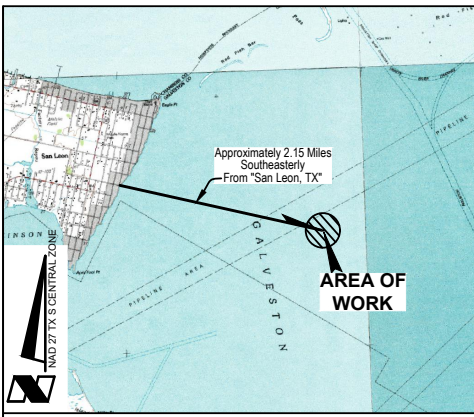

Topography obtained from U.S. Geological Survey Quadrangle "Galveston, TX."
VICINITY MAP
SCALE: 1"=10,000'

PROPOSED WELL, STRUCTURES & SHELL PAD:
WR PRODUCTION, LLC-
STATE TRACT 329 PROSPECT
X = 3,310,003.57' (NAD27 Tx SC)
Y = 620,131.33'
X = 3,278,409.13' (NAD83/2011 Tx SC)
Y = 13,743,567.05'
LAT. 29° 28' 32.5" N (NAD83/2011)
LONG. 94° 52' 55.4" W

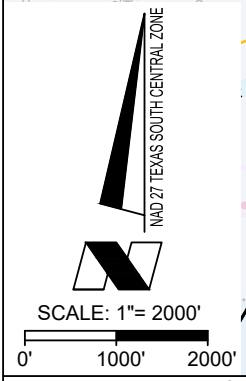

C. H. Fenstermaker & Associates, L.L.C.
135 Regency Sq.
Lafayette, LA 70508
Ph. 337-237-2200
Fax. 337-232-3299
TX Firm 10028500

NOTE:
THE CONTENTS OF THESE PLANS ARE INTENDED EXCLUSIVELY FOR THE PURPOSE OF OBTAINING ENVIRONMENTAL COMPLIANCE PERMITS

REVISIONS	
06/20/2024 BOR	Added vicinity map.

DRAWN BY: BOR	PROJ. MGR.: BOR
DATE: 04/29/2024	
JOB#: 2247306.00	SHEET 1 OF 4

PRELIMINARY
THIS DOCUMENT SHALL NOT BE RECORDED FOR ANY PURPOSE AND SHALL NOT BE USED OR VIEWED OR RELIED UPON AS A FINAL SURVEY DOCUMENT

WR PRODUCTION, LLC
STATE TRACT 329 PROSPECT
PROPOSED WELL, STRUCTURES & SHELL PAD
SITUATED IN
GALVESTON BAY
GALVESTON COUNTY, TEXAS

T:\2024\2247306\DWG\State Tract 329 COE.dwg

EXISTING PIPELINES	
STATE TRACT LINES	
PROPOSED ACCESS ROUTE	
BUOYS	
OYSTER LEASE AREAS TIED IN	
500' OYSTER BUFFER	
COE NAVIGATIONAL CHANNELS (DATA OBTAINED FROM US ARMY CORPS OF ENGINEERS)	

ACCESS CENTERLINE COORDINATE TABLE						
PT	NAD27 TxSC		NAD 83/2011 TxSC		NAD83/2011	
	Northing	Easting	Northing	Easting	Latitude	Longitude
1	616,680.56'	3,310,465.18'	13,740,116.28'	3,278,870.76'	29° 27' 58.2" N	94° 52' 51.6" W
2	619,792.51'	3,310,024.81'	13,743,228.23'	3,278,430.37'	29° 28' 29.2" N	94° 52' 55.3" W
3	620,131.33'	3,310,003.57'	13,743,567.05'	3,278,409.13'	29° 28' 32.5" N	94° 52' 55.4" W

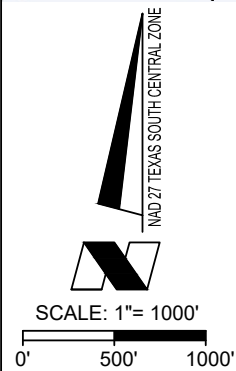
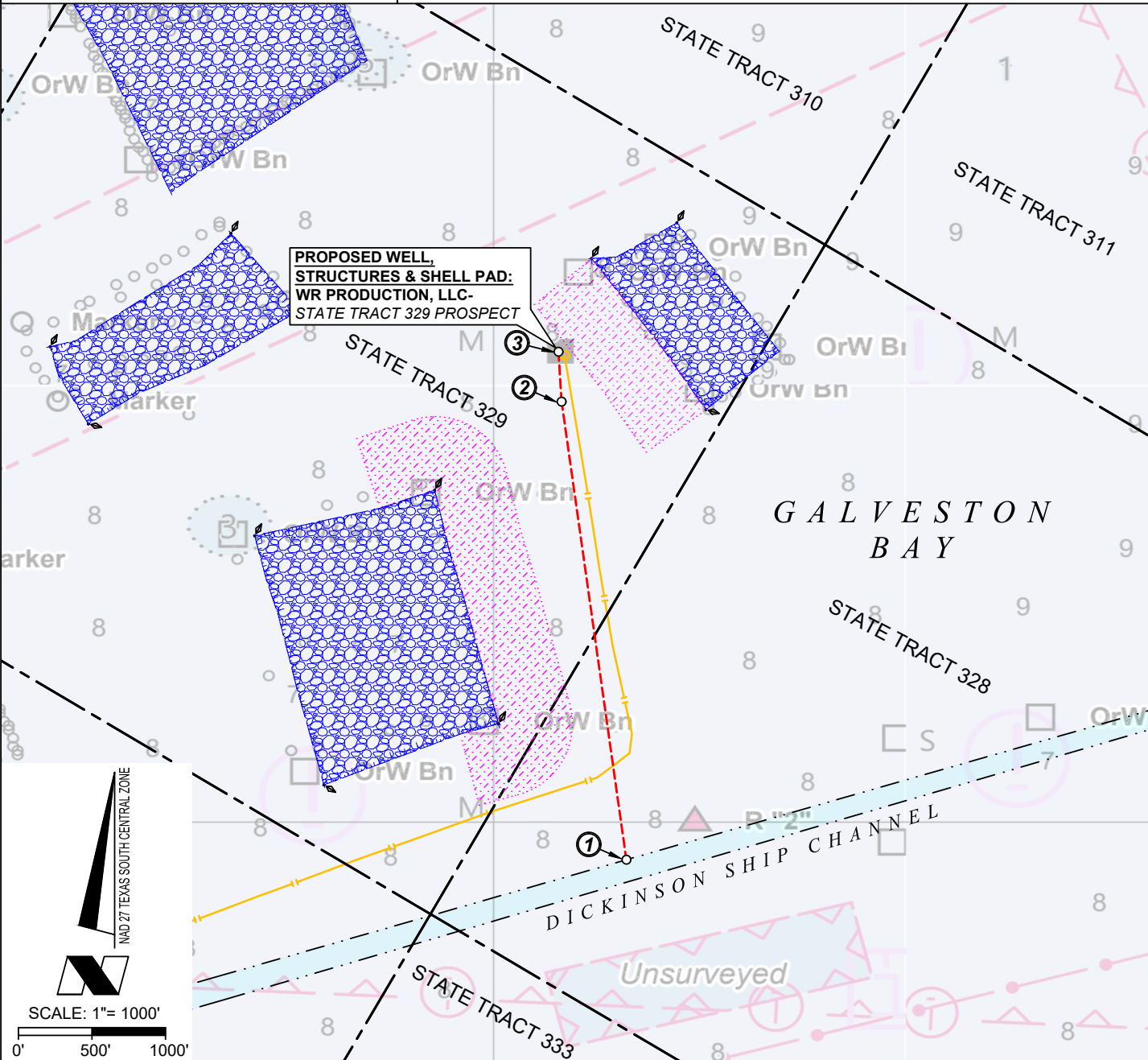

FENSTERMAKER
C. H. Fenstermaker & Associates, L.L.C.
135 Regency Sq.
Lafayette, LA 70508
Ph. 337-237-2200
Fax. 337-232-3299
TX Firm 10028500

NOTE:
THE CONTENTS OF THESE PLANS ARE INTENDED EXCLUSIVELY FOR THE PURPOSE OF OBTAINING ENVIRONMENTAL COMPLIANCE PERMITS

REVISIONS	
06/20/2024 BOR	Added vicinity map.
DRAWN BY: BOR	PROJ. MGR.: BOR
DATE: 04/29/2024	
JOB#: 2247306.00	SHEET 2 OF 4

PRELIMINARY
THIS DOCUMENT SHALL NOT BE RECORDED FOR ANY PURPOSE AND SHALL NOT BE USED OR VIEWED OR RELIED UPON AS A FINAL SURVEY DOCUMENT

WR PRODUCTION, LLC
STATE TRACT 329 PROSPECT
PROPOSED WELL, STRUCTURES & SHELL PAD
SITUATED IN
GALVESTON BAY
GALVESTON COUNTY, TEXAS

T:\2024\2247306\DWG\State Tract 329 COE.dwg

EXISTING PIPELINES	
STATE TRACT LINES	
PROPOSED ACCESS ROUTE	
BUOYS	
OYSTER LEASE AREAS TIED IN	
500' OYSTER BUFFER	
COE NAVIGATIONAL CHANNELS (DATA OBTAINED FROM US ARMY CORPS OF ENGINEERS)	

PROPOSED WELL, STRUCTURES & SHELL PAD:
WR PRODUCTION, LLC-
STATE TRACT 329 PROSPECT

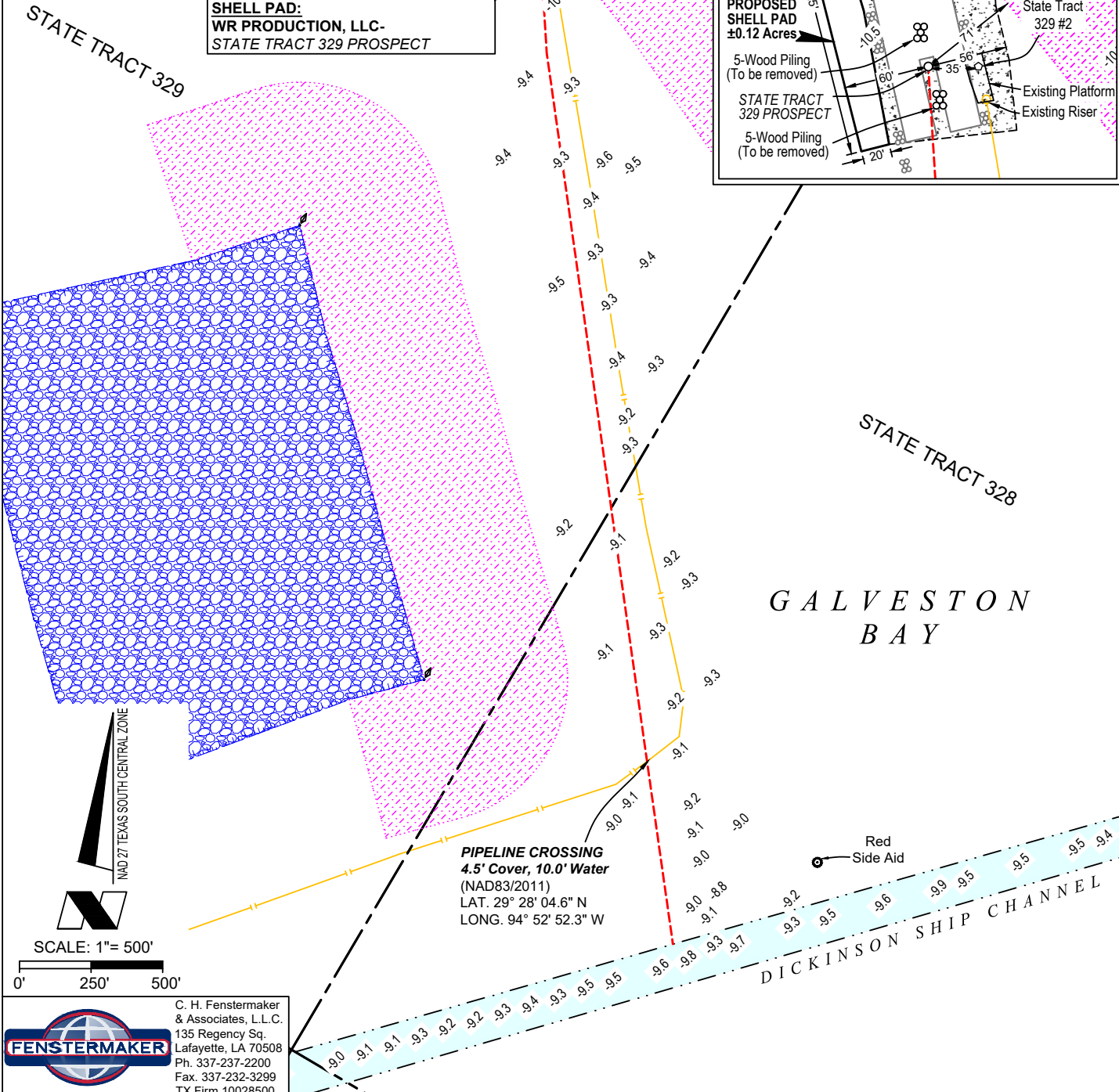
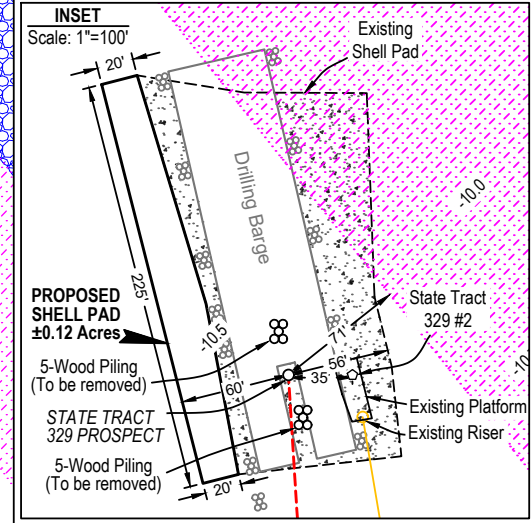

PIPELINE CROSSING
4.5' Cover, 10.0' Water
(NAD83/2011)
LAT. 29° 28' 04.6" N
LONG. 94° 52' 52.3" W

FENSTERMAKER
C. H. Fenstermaker & Associates, L.L.C.
135 Regency Sq.
Lafayette, LA 70508
Ph. 337-237-2200
Fax. 337-232-3299
TX Firm 10028500

REVISIONS	
06/20/2024 BOR	Added vicinity map.
DRAWN BY: BOR	PROJ. MGR.: BOR
DATE: 04/29/2024	
JOB#: 2247306.00	SHEET 3 OF 4

NOTE:
THE CONTENTS OF THESE PLANS ARE INTENDED EXCLUSIVELY FOR THE PURPOSE OF OBTAINING ENVIRONMENTAL COMPLIANCE PERMITS

PRELIMINARY
THIS DOCUMENT SHALL NOT BE RECORDED FOR ANY PURPOSE AND SHALL NOT BE USED OR VIEWED OR RELIED UPON AS A FINAL SURVEY DOCUMENT

WR PRODUCTION, LLC
STATE TRACT 329 PROSPECT
PROPOSED WELL, STRUCTURES & SHELL PAD
SITUATED IN
GALVESTON BAY
GALVESTON COUNTY, TEXAS

T:\2024\2247306\DWG\State Tract 329 COE.dwg

NOTES:

1. Max draft of fully loaded vessels to be utilized is -8.0'.
2. In order to ensure the safety of all parties, the permittee shall contact the Texas One Call System (1-800-344-8377), a minimum of 48 hours prior to the commencement of any excavation (Digging, Dredging, Jetting, etc.) or demolition activity.
3. Structures will also be marked/lighted in accordance with U.S. Coast Guard regulations.
4. Access and all operations will take place in open water.
5. Oyster Lease boundaries were surveyed (Tied-In) from existing pvc pipe and buoy markings in the field.

MHWL 1.08' MLLW
MLWL 0.06' MLLW
Soundings adjusted to MLLW, as reported by NOAA Tidal Station, Eagle Point, Galveston Bay, TX, Station ID 8771013.

Proposed Shell Pad in Water Bottoms.....573 Cu.Yds

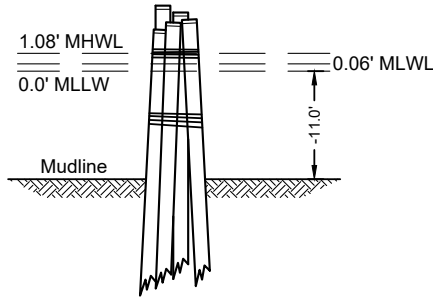

5 PILE CLUSTER
No Scale

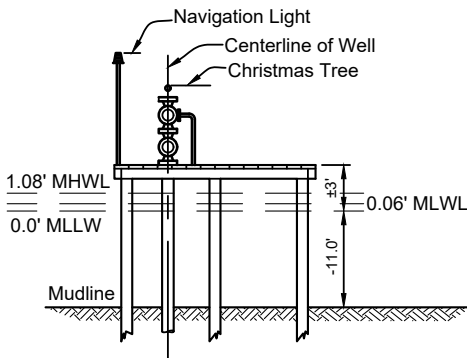
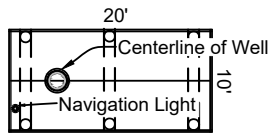

To be constructed upon successful completion of well.

TYPICAL 10' x 20' WELL PROTECTOR PLATFORM

No Scale

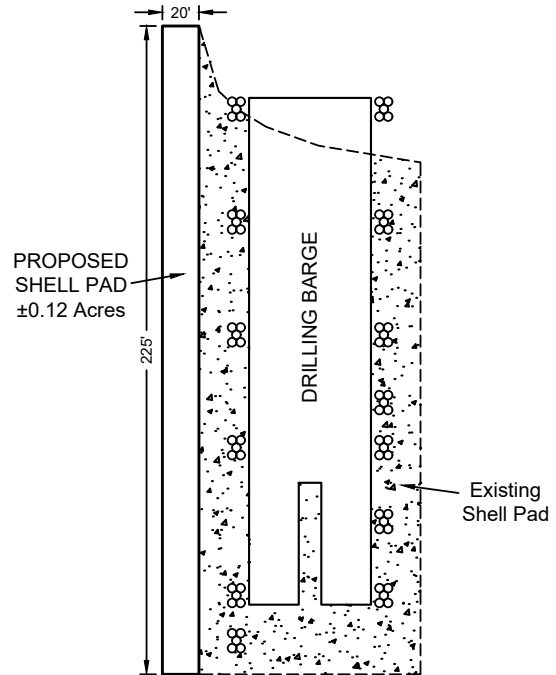

TYPICAL PILE CLUSTER LAYOUT

No Scale

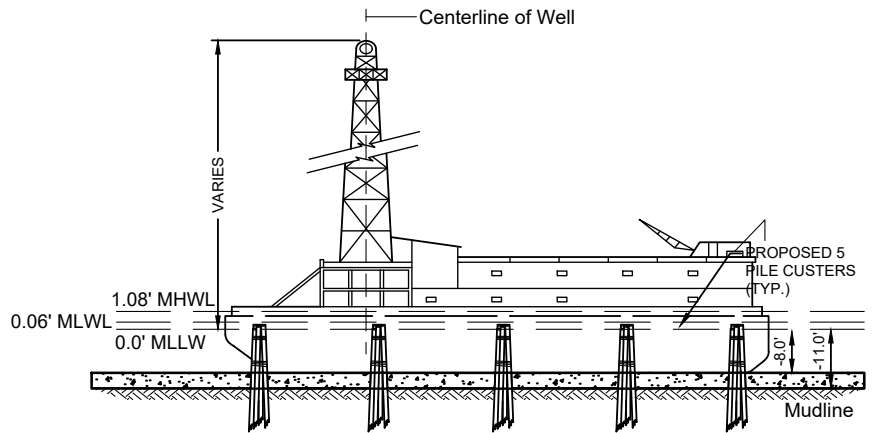

TYPICAL DRILLING BARGE

No Scale

FENSTERMAKER
C. H. Fenstermaker & Associates, L.L.C.
135 Regency Sq.
Lafayette, LA 70508
Ph. 337-237-2200
Fax. 337-232-3299
TX Firm 10028500

REVISIONS	
06/20/2024 BOR	Added vicinity map.
DRAWN BY: BOR	PROJ. MGR.: BOR
DATE: 04/29/2024	
JOB#: 2247306.00	SHEET 4 OF 4

NOTE:
THE CONTENTS OF THESE PLANS ARE INTENDED EXCLUSIVELY FOR THE PURPOSE OF OBTAINING ENVIRONMENTAL COMPLIANCE PERMITS

PRELIMINARY
THIS DOCUMENT SHALL NOT BE RECORDED FOR ANY PURPOSE AND SHALL NOT BE USED OR VIEWED OR RELIED UPON AS A FINAL SURVEY DOCUMENT

WR PRODUCTION, LLC
STATE TRACT 329 PROSPECT
PROPOSED WELL, STRUCTURES & SHELL PAD
SITUATED IN
GALVESTON BAY
GALVESTON COUNTY, TEXAS